



## QSR AVAILABLE

1713 James L Redman Pkwy  
Plant City, FL 33563

## DEMOGRAPHICS

	1 mile	3 mile	5 mile
Population	7,836	39,860	68,740
Average HH Income	\$77,056	\$86,200	\$91,891
Est. Total Employees	4,496	18,116	24,530
Est. Median Age	34.9	35.9	37.4

## PROJECT/MARKET HIGHLIGHTS

- Existing QSR building with a drive-thru available for sublease
- Building Size: 2,576 sq. ft.+/-, + drive-thru
- Located right before the signalized intersection of James L Redman Pkwy (22,000 vehicles per day AADT) & E Park Rd (6,300 vehicles per day AADT)
- Plant City is a well-established and centrally located suburban community, located approx. 12 miles west of Lakeland, 20 miles east of Brandon, and 25 miles east of Tampa
- Year Built: 2014 | Zoning: PD
- **THIS IS AN OPEN AND OPERATING RESTAURANT. PLEASE DO NOT DISTURB TENANT, EMPLOYEES OR GUESTS.**

FOR MORE INFORMATION CONTACT:

**Sandia Wasserman**

sandia@floridaretailpartners.com

**813.838.8680**

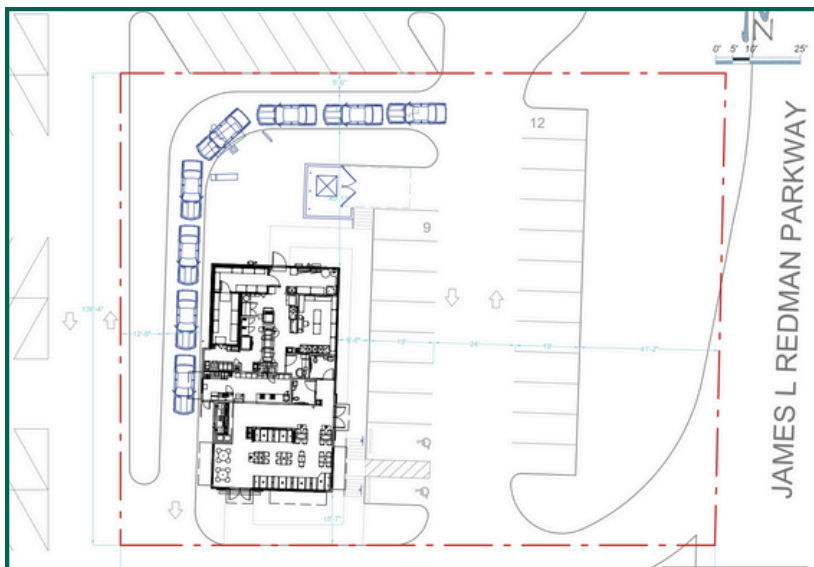

# QSR AVAILABLE

1713 James L Redman Pkwy  
Plant City, FL 33563

FOR MORE INFORMATION CONTACT:

**Sandia Wasserman**

**813.838.8680**



**PARTNER XTEAM**  
RETAIL ADVISORS

**FLORIDA**  
**RETAIL PARTNERS**  
| Licensed Real Estate Broker |

2202 S. MacDill Avenue | Tampa, FL 33629 | 813.251.3333

[www.floridaretailpartners.com](http://www.floridaretailpartners.com)